

Ürün açıklaması/Ürün resimleri



Açıklama

Malzeme:
İslah çeliği.

Model:
temperlenmiş ve perdahlı.

Bilgi:

Döner bağlama elemanları temel olarak iş parçalarını yerleştirmek ve çıkartmak için bağlama noktalarının serbest olması gerektiği yerlerde kullanılır.

* Tutamak üzerinden izin verilen el kuvveti.

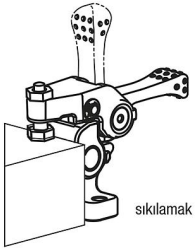
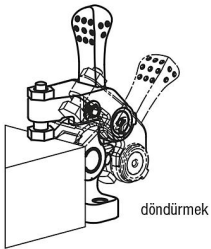
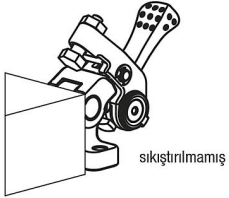

Çizimler

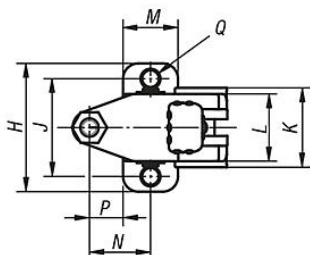
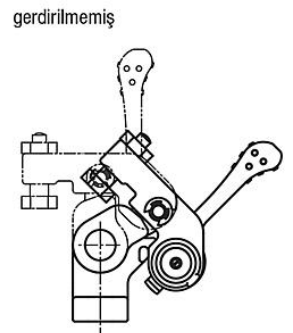
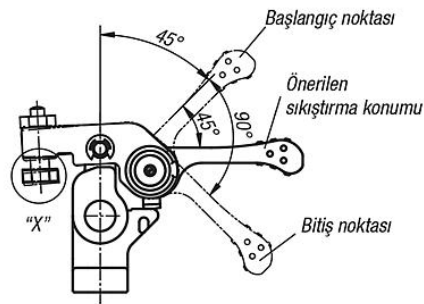
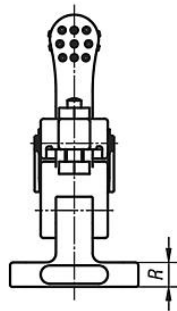
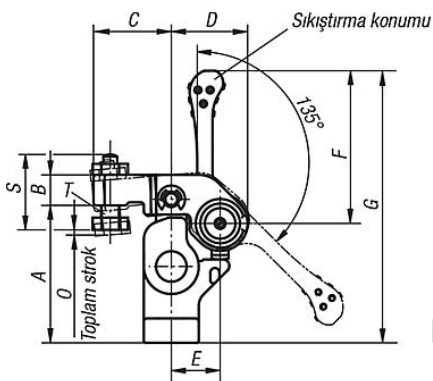

X görünümü

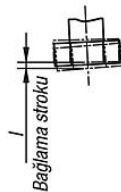

İşlenmemiş yüzeylerin gerdirilmesi

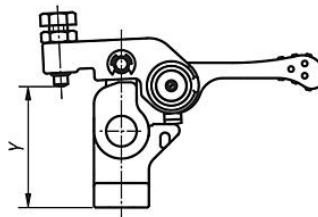

İşlenmiş yüzeylerin gerdirilmesi

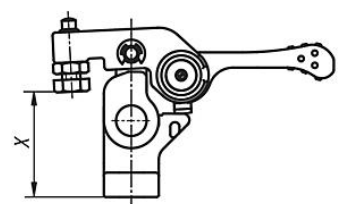

Ürünlere genel bakış

| Sipariş numarası | A | B | C | D | E | F | G | H | I | J | K | L | M | N | O | P | Q | R | S | T | X min. | X maks. | Y min. | Y maks. | Bağlama kuvveti N | El kuvveti FH N |
|------------------|----|----|------|----|----|----|-----|----|-----|----|----|----|----|----|-----|----|-----|----|------|----|--------|---------|--------|---------|-------------------|-----------------|
| 04610-100 | 45 | 10 | 25,5 | 25 | 16 | 50 | 89 | 42 | 1 | 32 | 26 | 22 | 18 | 20 | 1,5 | 11 | 5,5 | 8 | 24 | M6 | 31,5 | 40,5 | 34,5 | 43,5 | - | 100* |
| 04610-150 | 55 | 12 | 32 | 31 | 20 | 63 | 109 | 52 | 1,2 | 40 | 32 | 28 | 22 | 25 | 1,8 | 14 | 6,6 | 10 | 30,5 | M8 | 36,4 | 48,6 | 41,4 | 53,6 | - | 150* |